

## Cutting Diagram

# High Tech Tool Chest

2400 x 1200 x 6mm Hoop Pine Plywood (N + N to be placed below C)  
or use 1800 x 1800 x 6mm if available

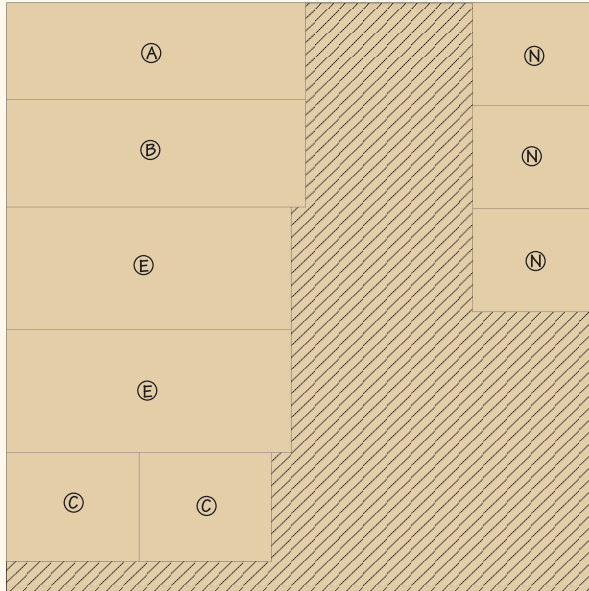

600 x 300 x 3mm Masonite

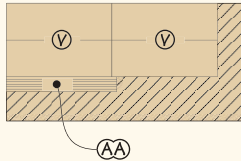

2400 x 140 x 19mm

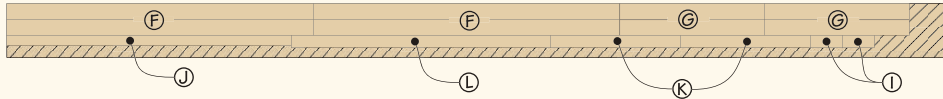

1200 x 140 x 19mm

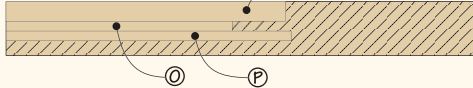

2400 x 140 x 12mm



2400 x 140 x 6mm

